

Hand Sanitising Hygiene Procedure.

Wash hands if visibly dirty.



Apply Verla Blue Hand Sanitiser to all surfaces of a cupped hand.



Rub hands palm to palm.

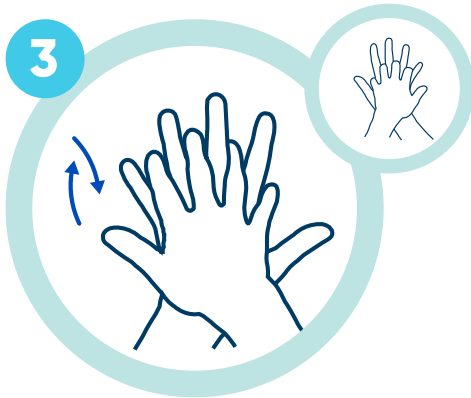

Right palm over left dorsum with interlaced fingers and vice versa;



Palm to palm with fingers interlaced;



Backs of fingers to opposing palms with fingers interlocked;



Rotational rubbing of left thumb clasped in right palm and vice versa;

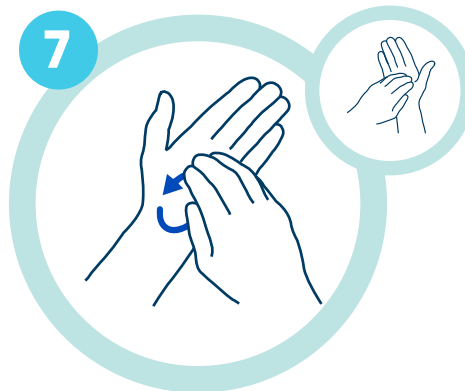

Rotational rubbing, backwards and forwards with clasped fingers of right hand in left palm and vice versa;



Once dry, your hands are safe.